

Site Add. : - Plot No.38, Old Subhedar, Near Durga Nagar Ground, Sakardhara, Nagpur - 440024

CREDIT

Architect Ar. Mahesh Padole	Structural Mr. Sudesh Malode	Legal Advisor Adv. Trupti Chimote - 9881744987, 8888823283
--------------------------------	---------------------------------	---

CONTACT FOR BOOKING
 HARISH GAJIMWAR
 9765566655

Project By

 तुमच्या आनंदाचा नवीन पत्ता....

Office Add. : Plot No. 73, Hindustan Colony, Devidas Apartment, Opp. Dew Hospital, Sai Mandir Sq., Wardha Road, Nagpur - 440015
 ✉ ayushinfragroup@gmail.com, 🌐 www.ayushinfra.com

Note :
 The Purchaser has to pay the following charges separately
 1. M.S.E.B. meter deposit and networking charges.
 2. Registration, Stamp Duty, Legal & Documentation charges.
 3. Water meter with other networking charges.
 4. Advance deposit payment towards extra work other than specified.
 5. Applicable GST as per government norms.

This brochure is conceptual in nature & is by not means legal document. Ayush Infra reserve to right, to add, delete or alter any specification, elevation, floor plan.

Graphvivo Design Studio - 976256254

AYUSH Prestige

3 BHK ultra luxurious flat



The new Dream House is on its way to you

AYUSH *Prestige*

3 BHK ultra luxurious flat

These electrifying flats open the door for luxury and elite living at Ayush Prestige which is the most attractive and the hottest address of Nagpur. Equipped with the most exclusive amenities, the project has been marking its name in the real estate sector even before it is completed. The beautiful details are made to adore and live the most at Ayush Prestige. The rich details at Ayush Prestige allow you to break the bar of a boring lifestyle and opt for exclusivity. The enhanced features, the upgraded materials, the elite designs, the adorable creation is no doubt the best Nagpur that too at affordable prices.



Typical 1st To 6th Floor Plan

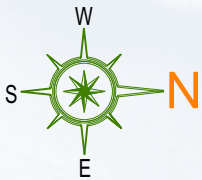

Typical 1st To 6th Floor Isometric Plan



AREA STATEMENT	
FLAT NO.	S/BUILD UP AREA
101, 201, 301 401, 501, 601	1600.00 Sq.ft

GROUND FLOOR PARKING PLAN

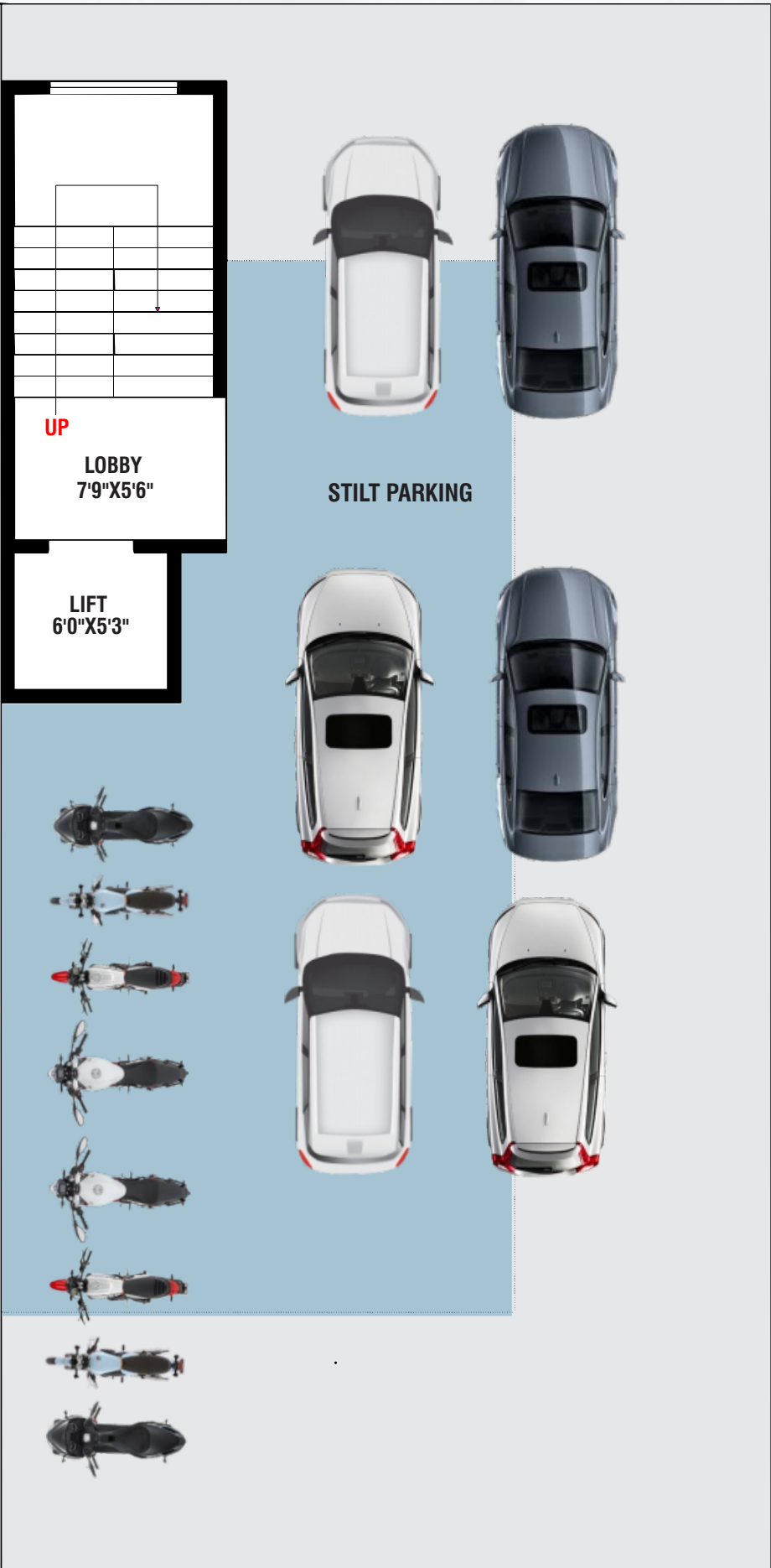

S P E C I F I C A T I O N S

- **STRUCTURE**
RCC framed structure
- **BRICKWORK**
Outer walls 6" thick
Inner walls 4.5" thick
- **PLASTER**
Internal walls: Smooth cement plaster finish
External walls: Sand faced & Smooth cement plaster finish
- **FLOORING**
Vitrified tiles (2'x4') in all rooms
Vitrified matt finish tiles in terrace area.
Antiskid ceramic tiles in bathroom & water closet area
- **KITCHEN**
Black Granite top kitchen platform with stainless steel sink
- **DADO**
Toilet Dado: Combination of ceramic tiles upto ceiling level
- **PAINTING**
External walls : Acrylic exterior paint
Internal walls : Plastic paint
Ceiling : Plastic paint
- **WINDOWS**
Powder coated Aluminum frame fitted with M.S. grill
- **PLUMBING & SANITATION**
Sanitary ware : Western commode, Seat cover, Wash basin of Simplo/ Jaquar/Hindware/Kohlar make
CP Fittings : Single lever diverter with spout, shower arm, Health faucet, Basin Mixer, Flush valve of Jaquar make sanitary ware in white colour.
Internal Plumbing : CPVC pipes & Fittings.
External Plumbing : UPVC pipes & Fittings.
Wash Basin Counter : Granite counter for counter top wash basin
- **ELECTRICAL**
Modular switches as per schedule (Legrand/ Gold Medal).
Electrical wires as per schedule (Polycab/ Anchor/ Grate White)
- **DOORS**
Main Door : Wooden frame with laminated flush door with night latch, Door stopper and handle
Bedroom Door : Wooden or granite or concrete door frame with laminated flush door with mortise lock & door Stopper
Toilet Door : Granite or concrete door frame inside with flush door with latch and handle
- **WATER SUPPLY**
Through corporation & well / borewell
- **LIFT**
Kone or Otis or Johnson make : Passenger lifts - 5 Nos.
- **SITE**
Iron main gate, Compound wall, Security cabin & landscaping
- **WATER PROOFING**
Water proofing for toilets blocks and common terrace at roof.
- **PARKING**
Parking of one car will be provided.
- **SPECIAL FEATURE**
Security Guard Room, Intercom Facility, CCTV Surveillance provided, EV Charging Point